

Bevel Seat Fittings



SS2C: 90° Elbow, 15TRF x 15TRF, Polish ID/OD						
Tube OD (Size)	A	B	C	D	Part Number 304	Part Number 316L
1"	2.218				SS2C7-1-304	SS2C7-1-316
1.5"	2.968				SS2C7-1.5-304	SS2C7-1.5-316
2"	3.750				SS2C7-2-304	SS2C7-2-316
2.5"	4.625				SS2C7-2.5-304	SS2C7-2.5-316
3"	5.406				SS2C7-3-304	SS2C7-3-316
4"	7.031				SS2C7-4-304	SS2C7-4-316



SS2E: 90° Elbow, 14PRF x 14PRF & Hex Nut (304) Both Ends, Polish ID/OD						
Tube OD (Size)	A	B	C	D	Part Number 304	Part Number 316L
1"	2.218				SS2E7-1-304	SS2E7-1-316
1.5"	2.968				SS2E7-1.5-304	SS2E7-1.5-316
2"	3.750				SS2E7-2-304	SS2E7-2-316
2.5"	4.625				SS2E7-2.5-304	SS2E7-2.5-316
3"	5.406				SS2E7-3-304	SS2E7-3-316
4"	7.031				SS2E7-4-304	SS2E7-4-316



SS2F: 90° Elbow, 15TRF x 14PRF & Hex Nut (304) on 14PRF End, Polish # 7						
Tube OD (Size)	A	B	C	D	Part Number 304	Part Number 316L
1"	2.218				SS2F7-1-304	SS2F7-1-316
1.5"	2.968				SS2F7-1.5-304	SS2F7-1.5-316
2"	3.750				SS2F7-2-304	SS2F7-2-316
2.5"	4.625				SS2F7-2.5-304	SS2F7-2.5-316
3"	5.406				SS2F7-3-304	SS2F7-3-316
4"	7.031				SS2F7-4-304	SS2F7-4-316



SS2K: 45° Elbow, 15TRF x 15TRF, Polish ID/OD						
Tube OD (Size)	A	B	C	D	Part Number 304	Part Number 316L
1"	1.343				SS2K7-1-304	SS2K7-1-316
1.5"	1.655				SS2K7-1.5-304	SS2K7-1.5-316
2"	2.000				SS2K7-2-304	SS2K7-2-316
2.5"	2.437				SS2K7-2.5-304	SS2K7-2.5-316
3"	2.781				SS2K7-3-304	SS2K7-3-316
4"	3.531				SS2K7-4-304	SS2K7-4-316



SS2P: 45° Elbow, 15TRF x 14PRF & Hex Nut (304) on 14PRF End Polish ID/OD						
Tube OD (Size)	A	B	C	D	Part Number 304	Part Number 316L
1"	1.343				SS2P7-1-304	SS2P7-1-316
1.5"	1.655				SS2P7-1.5-304	SS2P7-1.5-316
2"	2.000				SS2P7-2-304	SS2P7-2-316
2.5"	2.437				SS2P7-2.5-304	SS2P7-2.5-316
3"	2.781				SS2P7-3-304	SS2P7-3-316
4"	3.531				SS2P7-4-304	SS2P7-4-316

Bevel Seat Fittings



SS7: Tee, 151RF on all ends, Polish ID/OD						
Tube OD (Size)	A	B	C	D	Part Number 304	Part Number 316L
1"	3.686	1.843			SS7-1-304	SS7-1-316
1.5"	4.750	2.375			SS7-1.5-304	SS7-1.5-316
2"	5.625	2.812			SS7-2-304	SS7-2-316
2.5"	6.438	3.219			SS7-2.5-304	SS7-2.5-316
3"	7.000	3.500			SS7-3-304	SS7-3-316
4"	8.938	4.469			SS7-4-304	SS7-4-316

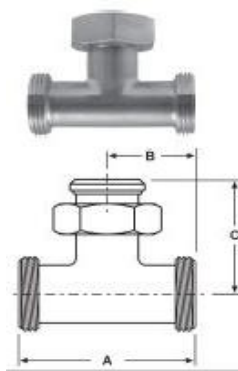

SS7A: Tee, 151RF on both runs 14PRF + 13H (304) on branch, Polish ID/OD						
Tube OD (Size)	A	B	C	D	Part Number 304	Part Number 316L
1"	3.686	1.843	2.500		SS7A-1-304	SS7A-1-316
1.5"	4.750	2.375	3.156		SS7A-1.5-304	SS7A-1.5-316
2"	5.625	2.812	4.062		SS7A-2-304	SS7A-2-316
2.5"	6.375	3.219	4.094		SS7A-2.5-304	SS7A-2.5-316
3"	7.000	3.500	4.344		SS7A-3-304	SS7A-3-316
4"	9.312	4.469	5.188		SS7A-4-304	SS7A-4-316

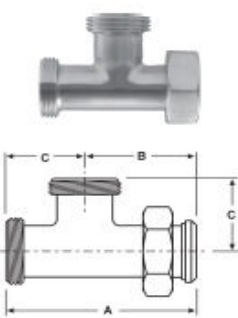

SS7B: Tee, 151RF on (1) run x 14PRF + 13H (304) on (1) run x 151RF on Branch-- # 7						
Tube OD (Size)	A	B	C	D	Part Number 304	Part Number 316L
1"	4.312	2.500	1.843		SS7B-1-304	SS7B-1-316
1.5"	5.531	3.156	2.375		SS7B-1.5-304	SS7B-1.5-316
2"	6.843	4.062	2.812		SS7B-2-304	SS7B-2-316
2.5"	7.281	4.094	3.219		SS7B-2.5-304	SS7B-2.5-316
3"	7.844	4.344	3.500		SS7B-3-304	SS7B-3-316
4"	9.844	5.188	4.469		SS7B-4-304	SS7B-4-316

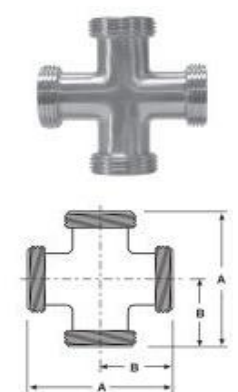

SS9: Cross, 151RF on all ends, Polish ID/OD						
Tube OD (Size)	A	B	C	D	Part Number 304	Part Number 316L
1"	3.625	1.812			SS9-1-304	SS9-1-316
1.5"	4.750	2.375			SS9-1.5-304	SS9-1.5-316
2"	5.562	2.781			SS9-2-304	SS9-2-316
2.5"	6.375	3.187			SS9-2.5-304	SS9-2.5-316
3"	7.000	3.500			SS9-3-304	SS9-3-316
4"	9.312	4.656			SS9-4-304	SS9-4-316

Bevel Seat Fittings

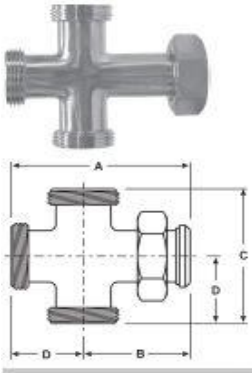

SS9A: Cross, *15TRF x 14PRF + 13H (304)*, Polish ID/OD

Tube OD (Size)	A	B	C	D	Part Number 304	Part Number 316L
1"	4.500	2.688	3.625	1.812	SS9A-1-304	SS9A-1-316
1.5"	6.594	3.406	4.750	2.375	SS9A-1.5-304	SS9A-1.5-316
2"	6.594	3.813	5.562	2.781	SS9A-2-304	SS9A-2-316
2.5"	7.438	4.250	6.375	3.187	SS9A-2.5-304	SS9A-2.5-316
3"	8.125	4.625	7.000	3.500	SS9A-3-304	SS9A-3-316
4"	10.78	6.125	9.312	4.656	SS9A-4-304	SS9A-4-316

SS13H: Union Hex Nut



Tube OD (Size)	A	B	C	D	Part Number 304
1"	0.906	1.812			SS13H-1-304
1.5"	0.968	2.406			SS13H-1.5-304
2"	1.062	3.000			SS13H-2-304
2.5"	1.187	3.594			SS13H-2.5-304
3"	1.281	4.188			SS13H-3-304
4"	1.500	5.438			SS13H-4-304

SS14PRF: *SHORT Plain* Bevel Ferrule



Tube OD (Size)	A	B	C	D	Part Number 304	Part Number 316L
1"	0.718	0.870			SS14PRF-1-304	SS14PRF-1-316
1.5"	0.718	1.370			SS14PRF-1.5-304	SS14PRF-1.5-316
2"	0.750	1.870			SS14PRF-2-304	SS14PRF-2-316
2.5"	0.875	2.370			SS14PRF-2.5-304	SS14PRF-2.5-316
3"	0.906	2.870			SS14PRF-3-304	SS14PRF-3-316
4"	1.031	3.834			SS14PRF-4-304	SS14PRF-4-316

SS14A: *LONG Plain* Bevel Ferrule



Tube OD (Size)	A	B	C	D	Part Number 304	Part Number 316L
1"	1.375	0.870			SS14A-1-304	SS14A-1-316
1.5"	1.500	1.370			SS14A-1.5-304	SS14A-1.5-316
2"	1.500	1.870			SS14A-2-304	SS14A-2-316
2.5"	1.750	2.370			SS14A-2.5-304	SS14A-2.5-316
3"	1.750	2.870			SS14A-3-304	SS14A-3-316
4"	1.750	3.834			SS14A-4-304	SS14A-4-316

SS14AHR: 14PRF Bevel *Rubber Hose* Adapter

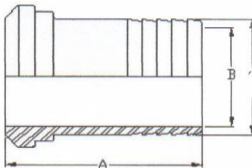

Tube OD (Size)	A	B	C	D	Part Number 304	Part Number 316L
1"	1.687	0.870	1.000		SS14AHR-1-304	SS14AHR-1-316
1.5"	1.687	1.370	1.500		SS14AHR-1.5-304	SS14AHR-1.5-316
2"	2.312	1.870	2.000		SS14AHR-2-304	SS14AHR-2-316
2.5"	2.343	2.370	2.500		SS14AHR-2.5-304	SS14AHR-2.5-316
3"	3.500	2.870	3.000		SS14AHR-3-304	SS14AHR-3-316
4"	4.000	3.834	4.000		SS14AHR-4-304	SS14AHR-4-316

Bevel Seat Fittings

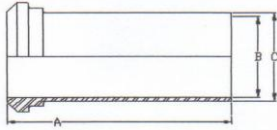

SS14AHT: 14PRF Bevel TYGON® Hose Adapter

Tube OD (Size)	A	B	C	D	Part Number 304	Part Number 316L
1"	4.688	0.870	1.000		SS14AHT-1-304	SS14AHT-1-316
1.5"	4.719	1.370	1.500		SS14AHT-1.5-304	SS14AHT-1.5-316
2"	4.719	1.870	2.000		SS14AHT-2-304	SS14AHT-2-316
2.5"	4.844	2.370	2.500		SS14AHT-2.5-304	SS14AHT-2.5-316
3"	4.906	2.870	3.000		SS14AHT-3-304	SS14AHT-3-316
4"	5.218	3.834	4.000		SS14AHT-4-304	SS14AHT-4-316



SS14: RECESSED 14PRF Bevel Ferrule

Tube OD (Size)	A	B	C	D	Part Number 304	Part Number 316L
1"	0.750	0.500	0.870	1.000	SS14-1-304	SS14-1-316
1.5"	0.875	0.625	1.370	1.500	SS14-1.5-304	SS14-1.5-316
2"	0.969	0.688	1.870	2.000	SS14-2-304	SS14-2-316
2.5"	1.062	0.750	2.370	2.500	SS14-2.5-304	SS14-2.5-316
3"	1.125	0.813	2.870	3.000	SS14-3-304	SS14-3-316
4"	1.250	0.938	3.834	4.000	SS14-4-304	SS14-4-316

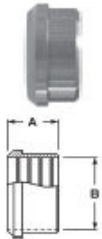

SS14R: RECESSLESS 14PRF Bevel Ferrule

Tube OD (Size)	A	B	C	D	Part Number 304	Part Number 316L
1"	0.750	1.000			SS14R-1-304	SS14R-1-316
1.5"	1.125	1.500			SS14R-1.5-304	SS14R-1.5-316
2"	1.312	2.000			SS14R-2-304	SS14R-2-316
2.5"	1.375	2.500			SS14R-2.5-304	SS14R-2.5-316
3"	1.437	3.000			SS14R-3-304	SS14R-3-316
4"	1.500	4.000			SS14R-4-304	SS14R-4-316

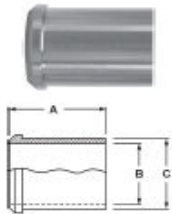

SS14W: Heavy Tank Spud 14PRF Bevel Ferrule

Tube OD (Size)	A	B	C	D	Part Number 304	Part Number 316L
1"	2.375	0.870	1.160		SS14W-1-304	SS14W-1-316
1.5"	2.531	1.370	1.676		SS14W-1.5-304	SS14W-1.5-316
2"	2.781	1.870	2.192		SS14W-2-304	SS14W-2-316
2.5"	3.062	2.370	2.708		SS14W-2.5-304	SS14W-2.5-316
3"	3.531	2.870	3.224		SS14W-3-304	SS14W-3-316
4"	4.312	3.834	4.256		SS14W-4-304	SS14W-4-316

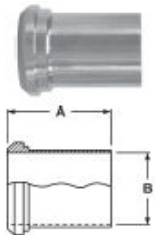

SS14WL: LIGHT Tank Spud 14PRF Bevel Ferrule

Tube OD (Size)	A	B	C	D	Part Number 304	Part Number 316L
1"	2.000	0.870			SS14WL-1-304	SS14WL-1-316
1.5"	2.250	1.370			SS14WL-1.5-304	SS14WL-1.5-316
2"	2.500	1.870			SS14WL-2-304	SS14WL-2-316
2.5"	2.75	2.370			SS14WL-2.5-304	SS14WL-2.5-316
3"	3.000	2.870			SS14WL-3-304	SS14WL-3-316
4"	4.000	3.834			SS14WL-4-304	SS14WL-4-316

Bevel Seat Fittings

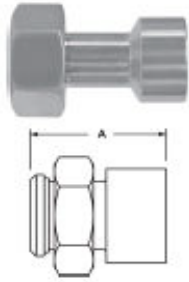

SS14-18: 14PRF + 13H (304) x Female NPT Adapter						
Tube OD (Size)	A	B	C	D	Part Number 304	Part Number 316L
1"	2.500				SS14-18-1-304	SS14-18-1-316
1.5"	3.250				SS14-18-1.5-304	SS14-18-1.5-316
2"	3.312				SS14-18-2-304	SS14-18-2-316
2.5"	3.375				SS14-18-2.5-304	SS14-18-2.5-316
3"	3.562				SS14-18-3-304	SS14-18-3-316
4"	3.750				SS14-18-4-304	SS14-18-4-316



SS14-19: 14PRF + 13H (304) x Male NPT Adapter						
Tube OD (Size)	A	B	C	D	Part Number 304	Part Number 316L
1"	3.125				SS14-19-1-304	SS14-19-1-316
1.5"	3.250				SS14-19-1.5-304	SS14-19-1.5-316
2"	3.312				SS14-19-2-304	SS14-19-2-316
2.5"	4.000				SS14-19-2.5-304	SS14-19-2.5-316
3"	4.250				SS14-19-3-304	SS14-19-3-316
4"	4.312				SS14-19-4-304	SS14-19-4-316

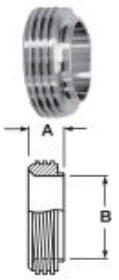

SS15TRF: SHORT Threaded Bevel Ferrule						
Tube OD (Size)	A	B	C	D	Part Number 304	Part Number 316L
1"	0.718	0.870			SS15TRF-1-304	SS15TRF-1-316
1.5"	0.718	1.370			SS15TRF-1.5-304	SS15TRF-1.5-316
2"	0.750	1.870			SS15TRF-2-304	SS15TRF-2-316
2.5"	0.875	2.370			SS15TRF-2.5-304	SS15TRF-2.5-316
3"	0.906	2.870			SS15TRF-3-304	SS15TRF-3-316
4"	1.031	3.834			SS15TRF-4-304	SS15TRF-4-316

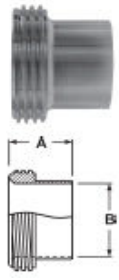

SS15A: LONG Threaded Bevel Ferrule						
Tube OD (Size)	A	B	C	D	Part Number 304	Part Number 316L
1"	1.375	0.870			SS15A-1-304	SS15A-1-316
1.5"	1.500	1.370			SS15A-1.5-304	SS15A-1.5-316
2"	1.500	1.870			SS15A-2-304	SS15A-2-316
2.5"	1.750	2.370			SS15A-2.5-304	SS15A-2.5-316
3"	1.750	2.870			SS15A-3-304	SS15A-3-316
4"	1.750	3.834			SS15A-4-304	SS15A-4-316

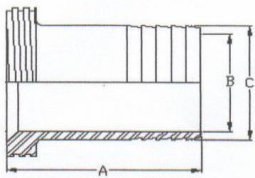

SS15AHR: 15TRF Bevel Rubber Hose Adapter						
Tube OD (Size)	A	B	C	D	Part Number 304	Part Number 316L
1"	1.687	0.870	1.000		SS15AHR-1-304	SS15AHR-1-316
1.5"	1.687	1.370	1.500		SS15AHR-1.5-304	SS15AHR-1.5-316
2"	2.312	1.870	2.000		SS15AHR-2-304	SS15AHR-2-316
2.5"	2.343	2.370	2.500		SS15AHR-2.5-304	SS15AHR-2.5-316
3"	3.500	2.870	3.000		SS15AHR-3-304	SS15AHR-3-316
4"	4.000	3.834	4.000		SS15AHR-4-304	SS15AHR-4-316

Bevel Seat Fittings

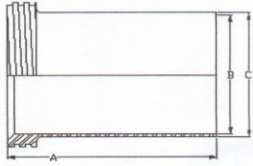

SS15AHT: 15TRF Bevel <i>YIGON®</i> Hose Adapter						
Tube OD (Size)	A	B	C	D	Part Number 304	Part Number 316L
1"	4.500	0.870	1.000		SS15AHT-1-304	SS15AHT-1-316
1.5"	4.500	1.370	1.500		SS15AHT-1.5-304	SS15AHT-1.5-316
2"	4.500	1.870	2.000		SS15AHT-2-304	SS15AHT-2-316
2.5"	4.500	2.370	2.500		SS15AHT-2.5-304	SS15AHT-2.5-316
3"	4.500	2.870	3.000		SS15AHT-3-304	SS15AHT-3-316
4"	5.000	3.834	4.000		SS15AHT-4-304	SS15AHT-4-316



SS15: <i>RECESSED</i> 15TRF Bevel Ferrule						
Tube OD (Size)	A	B	C	D	Part Number 304	Part Number 316L
1"	0.812	0.500	0.870	1.000	SS15-1-304	SS15-1-316
1.5"	0.875	0.625	1.370	1.500	SS15-1.5-304	SS15-1.5-316
2"	1.031	0.688	1.870	2.000	SS15-2-304	SS15-2-316
2.5"	1.125	0.750	2.370	2.500	SS15-2.5-304	SS15-2.5-316
3"	1.250	0.813	2.870	3.000	SS15-3-304	SS15-3-316
4"	1.375	0.938	3.834	4.000	SS15-4-304	SS15-4-316

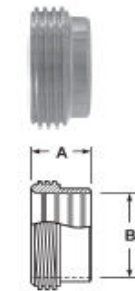

SS15R: <i>RECESSLESS</i> 15TRF Bevel Ferrule						
Tube OD (Size)	A	B	C	D	Part Number 304	Part Number 316L
1"	0.812	1.000			SS15R-1-304	SS15R-1-316
1.5"	1.125	1.500			SS15R-1.5-304	SS15R-1.5-316
2"	1.375	2.000			SS15R-2-304	SS15R-2-316
2.5"	1.500	2.500			SS15R-2.5-304	SS15R-2.5-316
3"	1.675	3.000			SS15R-3-304	SS15R-3-316
4"	1.675	4.000			SS15R-4-304	SS15R-4-316

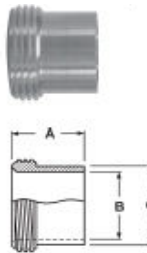

SS15W: <i>Heavy Tank Spud</i> 15W Bevel Ferrule						
Tube OD (Size)	A	B	C	D	Part Number 304	Part Number 316L
1"	1.500	0.870	1.250		SS15W-1-304	SS15W-1-316
1.5"	1.625	1.370	1.750		SS15W-1.5-304	SS15W-1.5-316
2"	1.750	1.870	2.312		SS15W-2-304	SS15W-2-316
2.5"	1.750	2.370	2.875		SS15W-2.5-304	SS15W-2.5-316
3"	1.812	2.870	3.375		SS15W-3-304	SS15W-3-316
4"	2.125	3.834	4.250		SS15W-4-304	SS15W-4-316

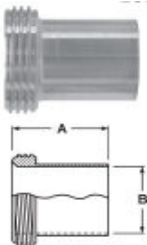

SS15WL: <i>LIGHT Tank Spud</i> 15TRF Bevel Ferrule						
Tube OD (Size)	A	B	C	D	Part Number 304	Part Number 316L
1"	2.000	0.870			SS15WL-1-304	SS15WL-1-316
1.5"	2.250	1.370			SS15WL-1.5-304	SS15WL-1.5-316
2"	2.500	1.870			SS15WL-2-304	SS15WL-2-316
2.5"	2.75	2.370			SS15WL-2.5-304	SS15WL-2.5-316
3"	3.000	2.870			SS15WL-3-304	SS15WL-3-316
4"	4.000	3.834			SS15WL-4-304	SS15WL-4-316

Bevel Seat Fittings



SS16A--- Plain Bevel End Cap

Tube OD (Size)	A	B	C	D	Part Number 304	Part Number 316L
1"	1.312				SS16A-1-304	SS16A-1-316
1.5"	1.843				SS16A-1.5-304	SS16A-1.5-316
2"	2.375				SS16A-2-304	SS16A-2-316
2.5"	2.906				SS16A-2.5-304	SS16A-2.5-316
3"	3.437				SS16A-3-304	SS16A-3-316
4"	4.500				SS16A-4-304	SS16A-4-316

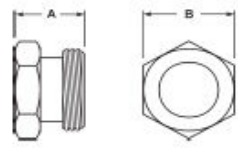

SS16AT--- Threaded Bevel End Cap

Tube OD (Size)	A	B	C	D	Part Number 304	Part Number 316L
1"	1.250	2.000			SS16AT-1-304	SS16AT-1-316
1.5"	1.250	2.000			SS16AT-1.5-304	SS16AT-1.5-316
2"	1.281	2.625			SS16AT-2-304	SS16AT-2-316
2.5"	1.190	3.570			SS16AT-2.5-304	SS16AT-2.5-316
3"	1.285	4.185			SS16AT-3-304	SS16AT-3-316
4"	1.505	5.360			SS16AT-4-304	SS16AT-4-316



SS17C--- 15TRF x 15TRF Tube Assembly

Tube OD (Size)	A	B	C	D	Part Number 304	Part Number 316L
1"	1.375				SS17C-1-304**	SS17C-1-316**
1.5"	1.437				SS17C-1.5-304**	SS17C-1.5-316**
2"	1.437				SS17C-2-304**	SS17C-2-316**
2.5"	1.687				SS17C-2.5-304**	SS17C-2.5-316**
3"	1.812				SS17C-3-304**	SS17C-3-316**
4"	2.437				SS17C-4-304**	SS17C-4-316**

** Note: When ordering, please indicate length needed! **Made to Order**



SS17D--- 15TRF x 14PRF + 13H (304) Tube Assembly

Tube OD (Size)	A	B	C	D	Part Number 304	Part Number 316L
1"	2.875				SS17D-1-304**	SS17D-1-316**
1.5"	3.125				SS17D-1.5-304**	SS17D-1.5-316**
2"	3.375				SS17D-2-304**	SS17D-2-316**
2.5"	3.750				SS17D-2.5-304**	SS17D-2.5-316**
3"	3.875				SS17D-3-304**	SS17D-3-316**
4"	4.625				SS17D-4-304**	SS17D-4-316**

** Note: When ordering, please indicate length needed! **Made to Order**



SS17E--- 14PRF x 14PRF + 13H (304) Tube Assembly

Tube OD (Size)	A	B	C	D	Part Number 304	Part Number 316L
1"	2.875				SS17E-1-304**	SS17E-1-316**
1.5"	3.125				SS17E-1.5-304**	SS17E-1.5-316**
2"	3.375				SS17E-2-304**	SS17E-2-316**
2.5"	3.750				SS17E-2.5-304**	SS17E-2.5-316**
3"	3.875				SS17E-3-304**	SS17E-3-316**
4"	4.625				SS17E-4-304**	SS17E-4-316**

** Note: When ordering, please indicate length needed! **Made to Order**

Bevel Seat Fittings

SS21--- 15TRF x Male NPT Adapter

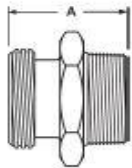

Tube OD (Size)	A	B	C	D	Part Number 304	Part Number 316L
1" x 1/2"	2.187				SS21-1 x 0.5- 304	SS21-1 x 0.5- 316
1" x 3/4"	2.187				SS21- 1 x 0.75-304	SS21- 1 x 0.75-316
1" x 1"	2.187				SS21- 1 x 1- 304	SS21- 1 x 1- 316
1.5" x 1/2"	2.437				SS21- 1.5 x 0.5-304	SS21- 1.5 x 0.5-316
1.5" x 3/4"	2.437				SS21- 1.5 x 0.75- 304	SS21- 1.5 x 0.75- 316
1.5" x 1"	2.312				SS21- 1.5 x 1- 304	SS21- 1.5 x 1- 316
1.5" x 1.5"	2.437				SS21- 1.5 x 1.5- 304	SS21- 1.5 x 1.5- 316
2" x 1.5"	2.469				SS21- 2 x 1.5"- 304	SS21- 2 x 1.5"- 316
2" x 2"	2.656				SS21- 2" x 2"- 304	SS21- 2" x 2"- 316
2.5" x 2.5"	2.781				SS21- 2.5 x 2.5- 304	SS21- 2.5 x 2.5- 316
3" x 3"	3.500				SS21- 3 x 3 -304	SS21- 3 x 3 -316
4" x 4"	3.813				SS21- 4 x 4- 304	SS21- 4 x 4- 316

SS22--- 15TRF x Female NPT Adapter

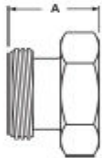

Tube OD (Size)	A	B	C	D	Part Number 304	Part Number 316L
1" x 1/2"	1.625				SS22-1 x 0.5- 304	SS22-1 x 0.5- 316
1" x 3/4"	1.625				SS22- 1 x 0.75-304	SS22- 1 x 0.75-316
1" x 1"	2.063				SS22- 1 x 1- 304	SS22- 1 x 1- 316
1.5" x 1/2"	1.625				SS22- 1.5 x 0.5-304	SS22- 1.5 x 0.5-316
1.5" x 3/4"	1.625				SS22- 1.5 x 0.75- 304	SS22- 1.5 x 0.75- 316
1.5" x 1"	2.500				SS22- 1.5 x 1- 304	SS22- 1.5 x 1- 316
1.5" x 1.5"	2.250				SS22- 1.5 x 1.5- 304	SS22- 1.5 x 1.5- 316
2" x 1.5"	1.656				SS22- 2 x 1.5"- 304	SS22- 2 x 1.5"- 316
2" x 2"	2.344				SS22- 2" x 2"- 304	SS22- 2" x 2"- 316
2.5" x 2.5"	2.094				SS22- 2.5 x 2.5- 304	SS22- 2.5 x 2.5- 316
3" x 3"	2.188				SS22- 3 x 3 -304	SS22- 3 x 3 -316
4" x 4"	2.625				SS22- 4 x 4- 304	SS22- 4 x 4- 316

SS23B---Plain Bevel Thermometer Cap

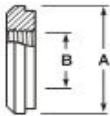

Tube OD (Size)	A	B	C	D	Part Number 304	Part Number 316L
1"	1.312	1/2" NPT			SS23B-1-304	SS23B-1-316
1.5"	1.843	3/4" NPT			SS23B-1.5-304	SS23B-1.5-316
2"	2.375	3/4" NPT			SS23B-2-304	SS23B-2-316
2.5"	2.906	3/4" NPT			SS23B-2.5-304	SS23B-2.5-316
3"	3.437	3/4" NPT			SS23B-3-304	SS23B-3-316
4"	4.500	3/4" NPT			SS23B-4-304	SS23B-4-316

SS28BL: 15TRF Bevel Seat Lateral, Polish ID/OD

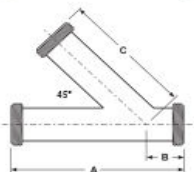

Tube OD (Size)	A	B	C	D	Part Number 304	Part Number 316L
1"	7.436	1.718	5.718		SS28BL7-1-304	SS28BL7-1-316
1.5"	8.810	1.905	6.905		SS28BL7-1.5-304	SS28BL7-1.5-316
2"	10.25	2.375	7.805		SS28BL7-2-304	SS28BL7-2-316
2.5"	11.75	2.375	9.375		SS28BL7-2.5-304	SS28BL7-2.5-316
3"	12.56	2.781	9.781		SS28BL7-3-304	SS28BL7-3-316
4"	14.87	3.093	11.78		SS28BL7-4-304	SS28BL7-4-316

Bevel Seat Fittings

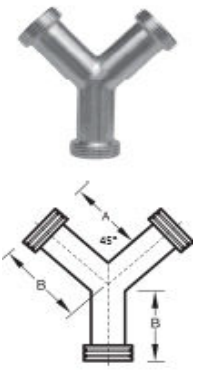

SS28BY: 15TRF Bevel Seat True "Y", Polish ID/OD						
Tube OD (Size)	A	B	C	D	Part Number 304	Part Number 316L
1"	2.718	3.156			SS28BY7-1-304	SS28BY7-1-316
1.5"	2.718	3.156			SS28BY7-1.5-304	SS28BY7-1.5-316
2"	3.375	4.000			SS28BY7-2-304	SS28BY7-2-316
2.5"	4.245	5.000			SS28BY7-2.5-304	SS28BY7-2.5-316
3"	4.906	5.781			SS28BY7-3-304	SS28BY7-3-316
4"	6.406	6.406			SS28BY7-4-304	SS28BY7-4-316

SS31PRF--- <u>Concentric</u> Reducing Ferrule						
Tube OD (Size)	A	B	C	D	Part Number 304	Part Number 316L
2" x 1.5"	0.718	2.194			SS31PRF- 2 x 1.5- 304	SS31PRF- 2 x 1.5- 316
2.5" x 2"	0.843	2.710			SS31PRF- 2.5 x 2- 304	SS31PRF- 2.5 x 2- 316
3" x 2"	0.906	3.226			SS31PRF- 3 x 2- 304	SS31PRF- 3 x 2- 316
Note: Other Sizes Available						

